



**RAM**

# THE NEW RAM 1500



OFFICIAL EUROPEAN IMPORTER



**THE NEXT LEVEL OF LUXURY**

# STRENGTH & CAPABILITY



## ALWAYS MOVING FORWARD

The Ram 1500 was built to pull heavy loads, haul supplies over gravel roads, and plow through the elements. Count on it to handle up to 1,000<sup>2</sup> kg max payload or tow up to 3,500 kg with complete confidence. The new available 3.0L Hurricane engine has been developed to improve both performance and fuel efficiency.

For those who venture off the beaten path, the Ram 1500 offers advanced off-road capabilities. The 4WD Auto system automatically adjusts power distribution between the front and rear axles, providing optimal traction on any terrain. In Auto mode, traction seamlessly shifts from the rear to the front in an instant if a loss of grip is detected, ensuring you're always in control, no matter the conditions.

Additionally, the available eLocker rear axle enhances your off-road experience by locking the rear differential when needed, ensuring both rear wheels move together for maximum traction. This feature is invaluable when tackling steep inclines, deep snow, or uneven terrain, giving you the confidence to conquer any challenge.

ACTIVE-LEVEL TECHNOLOGY AT WORK: IT AUTOMATICALLY KICKS IN WHEN WEIGHT IS ADDED TO THE BED, MAINTAINING A CONSTANT AND LEVEL PROFILE.

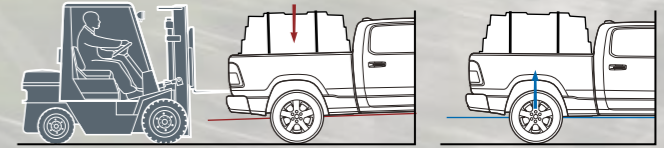

# 1.000 KG MAX PAYLOAD

**BUILT TO DO THE JOB RIGHT, EVERY TIME.**

The reduced weight of the Ram 1500 helps increase payload capacity, allowing you to make every load count. The Ram 1500 offers stunning hauling capability, delivering up to 1.000 kg of brute carrying strength while providing a ride that matches comfort with capability. Add further hauling assets—such as the available RamBox® Cargo Management System, shown here—and you've got what it takes to get the job done.



# 3.500 KG MAX TOWING

## POWER TO THE CORE

The RAM 1500's 3.0L Hurricane engine with twin turbos provides even more towing power with its enhanced torque. But it's not just about the numbers. While the maximum towing capacities of the RAM 1500 in the U.S. are nearly double, this highlights a significant difference in comfort and handling. With the added torque from the twin-turbo engine, the RAM 1500 excels in managing heavy loads, offering superior comfort and ease compared to other vehicles.

THE AVAILABLE AIR SUSPENSION SYSTEM SIMPLIFIES BALL/HITCH ALIGNMENT, COUNTERACTS WEIGHT FROM TRAILERING/HAULING, MAINTAINS AN EVEN AND LEVEL PROFILE WHEN LOADED, AND KEEPS RAKE CONSTANT FROM THE FRONT END TO THE REAR OF THE TRAILER.

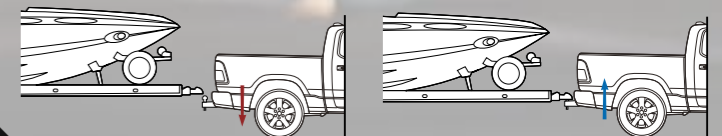



# MORE HORSEPOWER, MORE TORQUE, AND IMPROVED FUEL ECONOMY.

Discover the cutting-edge technology in the new engines, designed to enhance performance, efficiency, and driving experience:

- Plasma transfer wire arc (spray bore) coating in the cylinder bores for an ultra-thin, low-friction wear surface;
- Two low-inertia, high-flow turbochargers, optimized for each engine, feed three cylinders for rapid response to throttle inputs;
- Engine-mounted water-to-air charge cooler with a dedicated cooling circuit.



## MEET THE NEXT ENGINE GENERATION

The new Twin-Turbo 3.0L engine, part of the Hurricane family of **INLINE-SIX ENGINES**, offers two power outputs, providing the RAM 1500 with unprecedented power.

### NEW 3.0L HURRICANE TWIN-TURBO I-6 STANDARD-OUTPUT (SO) ENGINE

**420 Hp** Maximum Power

**636 Nm** Maximum Torque

**311 G/KM** CO2 EMISSIONS<sup>1</sup>

**13.1 L/100 KM** FUEL CONSUMPTION<sup>1</sup>

Optimized for fuel-efficient performance while delivering 25 more horsepower and an impressive 80 Nm more torque than a V8 engine, the Hurricane SO is a workhorse that provides increased horsepower, enhanced torque performance, and improved fuel economy. Its reduced greenhouse emissions further enhance its appeal.

### NEW 3.0L HURRICANE TWIN-TURBO I-6 HIGH-OUTPUT (HO) ENGINE

**540 Hp** Maximum Power

**706 Nm** Maximum Torque

**338 G/KM** CO2 EMISSIONS<sup>1</sup>

**14.2 L/100 KM** FUEL CONSUMPTION<sup>1</sup>

A high-performance engine powers this drive-train, making it the ideal choice for towing the heaviest loads. With 145 more horsepower and 150 Nm more torque than the V8, its twin turbos help maintain at least 90 percent of peak torque, even at redline, ensuring consistent pulling strength.

### HURRICANE'S TURBOCHARGERS

Each turbocharger in the Hurricane twin-turbo system feeds three cylinders. From a performance standpoint, two smaller turbochargers with less inertia spin up faster and deliver boost to the engine at lower RPMs compared to a single large turbo. The Hurricane twin-turbo flexes its muscle with a flat torque band, maintaining at least 90% of peak torque from 2,350 RPM all the way to its redline. The Hurricane's turbochargers are optimized for each version: the turbos on the Hurricane SO deliver a peak boost of 22 psi, while the Hurricane H/O turbos deliver a peak boost of 26 psi. A twin-turbo engine starts to deliver power early, and 420 HP has almost the same output as 540 HP under 2,500 RPM.

### REDUCED INTERIOR NOISE LEVELS

**Improved Acoustics** The vehicle features thicker and heavier outer dash silencers, a more robust hood silencer with increased density, additional fender noise reduction treatment, and increased carpet backing. These improvements collectively enhance the acoustic environment inside the cabin.

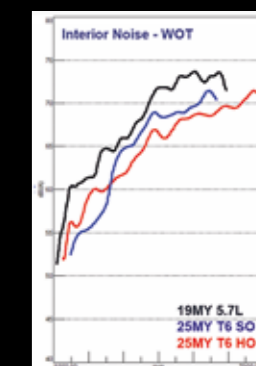

**Hurricane Improvements** The Hurricane engine has undergone enhanced mount tuning to reduce vibrations. The inline 6 engine offers smoother and quieter performance compared to the V8, providing a more refined driving experience. Additionally, the mirror flag has been redesigned to reduce wind buffeting, further contributing to overall noise reduction and enhancing the driving experience.

TRADESMAN	BIG HORN	SPORT	REBEL	LARAMIE	LIMITED	TUNGSTEN	RHO
420 HP	420 HP	420 HP	420 HP	420 HP	-	-	-
-	-	-	-	-	540 HP	540 HP	540 HP

<sup>1</sup> = Fuel consumption and CO2 emission data are calculated based on the WLTP Test Procedure combined cycle. These figures may vary as vehicles are continuously tested with the latest available cycle. Actual fuel consumption and emissions may vary depending on driving conditions, vehicle configuration, and other factors. Greenhouse emissions further enhance its appeal.



### 12-INCH DRIVER INFORMATION DISPLAY



Important insight about your drive directly in your line of sight. Beginning with a custom startup animation, this screen features a liquid crystal display with a balance of color and contrast and makes it easy to monitor your drive and the road.

### 14.4-INCH DISPLAY



14.4-inch Uconnect 5 NAV Radio. The largest touchscreen in its class. Split-screen cast two apps simultaneously with Profile orientation allows for multi app use

### DIGITAL REAR VIEW MIRROR



A digital display is paired with the conventional mirror to help provide a clearer look at what lies behind the vehicle.

### 10.25-INCH PASSENGER SCREEN



Front passengers have their own frameless, digital touchscreen. Full connectivity provides a seamless experience between a smartphone and the Uconnect® system.

### HEAD-UP DISPLAY



Head-Up Display projects vital driving information onto the windshield, keeping your eyes on the road and enhancing safety and convenience.

### DUAL WIRELESS CHARGING PAD



Keep your smartphones and devices charged up while on the go. The New Ram 1500 offers Class-Exclusive available dual wireless charging pads in the truck cabin for both driver and passenger convenience.

# OVER 100 AVAILABLE SAFETY & SECURITY FEATURES



## STANDARD FEATURES ACROSS THE ENTIRE LINEUP

### A ACTIVE LANE MANAGEMENT SYSTEM

Helps you stay in your lane.

### B PEDESTRIAN PROTECTION

Utilizes a front camera to detect people on the road ahead and notifies you via your Driver Information Display.

### C REAR BACK-UP CAMERA AND FR/RR PARK ASSIST W/STOP

Entering and exiting difficult parking spots, both front and rear, is made easy with an advanced set of sensors.

### D BLIND SPOT MONITORING (BSM) WITH TRAILER DETECTION & REAR CROSS-PATH DETECTION

Uses sensors to detect other vehicles in your blind-spot zones or crossing behind you, monitoring the space between you and other drivers and notifying you when a side or rear blind spot is encroached.

### E FORWARD COLLISION WARNING (FCW) PLUS

Sensors detect when the vehicle may be approaching another vehicle too rapidly, sending an audible and visual alert to the driver and providing active brake assistance if the driver does not react in time.

### F ADAPTIVE CRUISE CONTROL (ACC)

Automatically maintain desired vehicle speed and distance from vehicles in front of you. The system can bring the vehicle to a full stop without driver intervention to help avoid a collision. And our system operates down to 0 km/h.

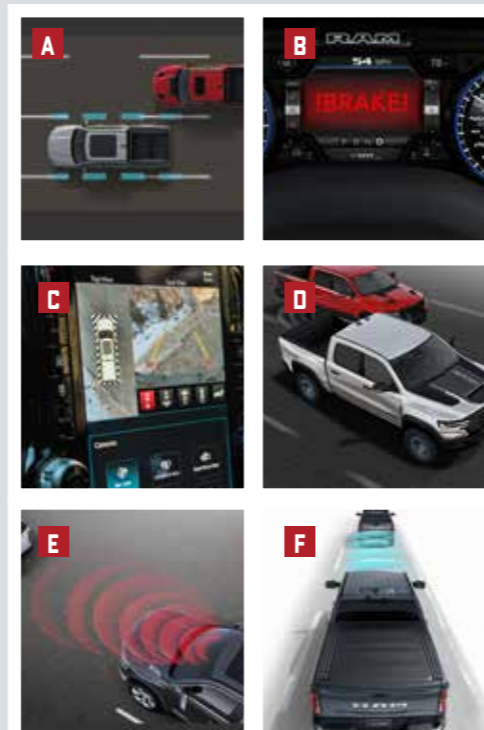

## SAFETY OPTIONALS WITH ADVANCED SAFETY GROUP II

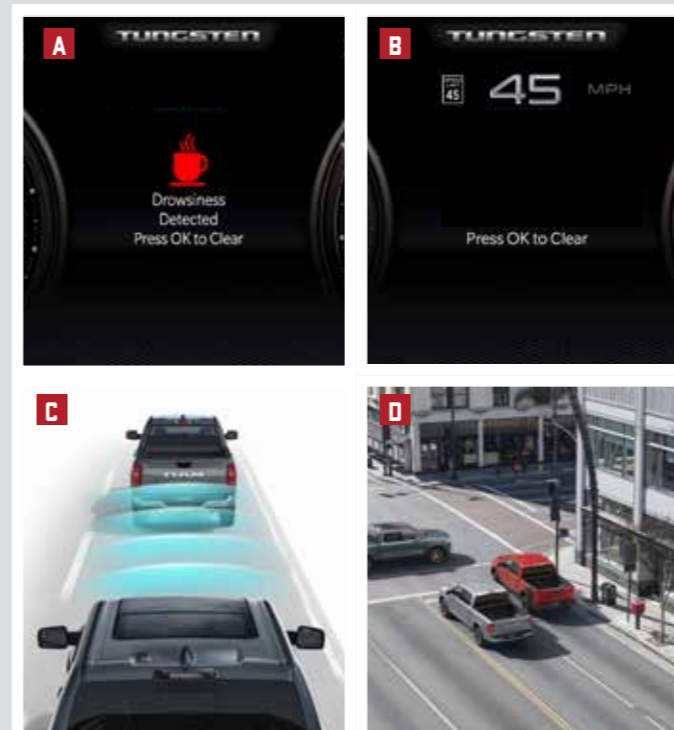

### A TRAFFIC SIGN RECOGNITION <sup>new</sup>

This available feature detects road signs and displays their information on the Driver Information Digital Cluster or Head-Up Display if equipped.

### B DROWSY DRIVER DETECTION <sup>new</sup>

This available system detects drowsiness behind the wheel and audibly and visually alerts the driver that getting rest is recommended.

### C EVASIVE STEER ASSIST <sup>new</sup>

This available system will attempt to aid the driver in making an evasive lane change if the Forward Collision Warning System warns of a possible frontal collision and the driver initiates an evasive steering maneuver into the next clear lane.

### D INTERSECTION COLLISION ASSIST SYSTEM

Detects the risk of collision with intersection cross-traffic, warns the driver of any oncoming risks and applies automatic braking when appropriate.



# ENGINEERED

# TO PERFORM

**NEW ELECTRONIC PARKING BRAKE**  
Five operational modes, including Safe Mode and Drive-Away Release.

**STRONGER ALL AROUND**  
Extensive use of high-strength steel makes this the toughest Ram 1500 ever.

**A STRONG FOUNDATION**  
98% of the steel used in the frame is high-strength steel.

**DYNAMIC FRONT CRUMPLE ZONES**  
Redesigned to handle greater impact load and absorb more energy.



**HEAVY-DUTY SHOCKS**  
Twin-tube, with Frequency Response Damping to enhance ride quality for both on and off-road driving.

**SIDE-IMPACT DOOR BEAMS**  
Reinforce the protection against potential side impacts.

**PROGRESSIVE-RATE REAR SPRINGS**  
Adapt to handle payload while maintaining a level ride and excellent ride quality.

**REAR AXLE THERMAL MANAGEMENT SYSTEM**  
This new available technology manages viscosity to help enhance fuel efficiency.

**TIRE BLOCKER**  
Offers further protection in the event of a frontal crash. Driver and passenger side.

**LARGER BRAKE ROTORS**  
Front and back, they fully measure up—nearly 380 mm.

**SPLAYED FRAME RAILS**  
Direct impact energy away from the cabin and to the frame rails.

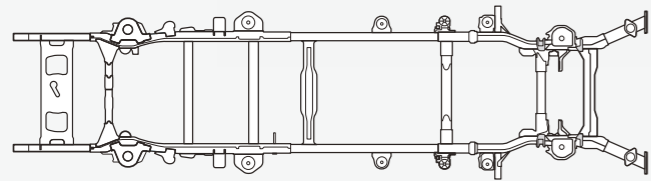

**THE START: A HIGH-STRENGTH STEEL FRAME**  
Tough starts with the foundation, and the Ram 1500 is built to last, with 98% of the steel used in the frame comprised of high-strength steel—while still achieving a 45 kg weight reduction.

Frame construction permits notable secondary improvements. Tow hooks attached to the front are outwardly mounted, with a weight-efficient, closed-loop design for improved strength. A tow hitch receiver mounted to the rear of the frame is standard on all models.

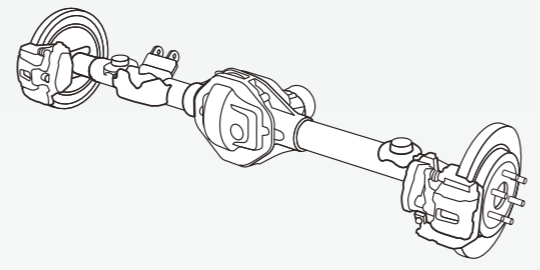

**NEW AXLES SHOWCASE STRENGTH AND TECHNOLOGY**  
Ride strong. Ram truck axles take capability to the next level.

Ram truck engineers refused to compromise, choosing a new 6-lug wheel design and a 9.25-inch (235 mm) rear axle, coating to haul up to 850 kg max payload or tow up to 3,500 kg. The new electronic parking brake relies on axle modifications for integrated caliper ears, along with new viscosity lube.

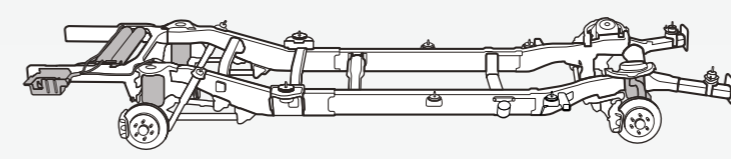

**THE FOUR-CORNER AIR SUSPENSION SYSTEM**  
Completely unique to the light-duty segment, the automatic or driver-operated Active-Level™ Four-Corner Air Suspension System is available on all trim levels. The system has been modified for Ram 1500, now with a redesigned air supply unit in a single unit to increase capability and reduce weight. It's also been retuned for the new, lighter-weight frame and chassis components.

The five operational modes include two Off-Road heights, Aero Mode, Normal Ride height and the Entry/Exit Mode.

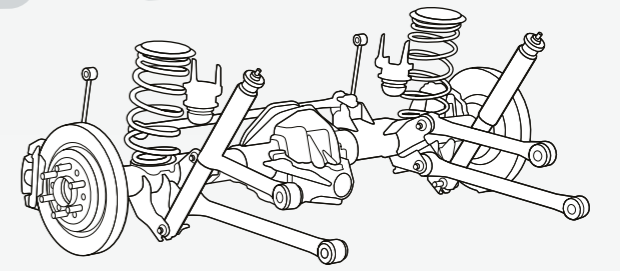

**FRONT AND REAR SUSPENSIONS**  
A new front suspension in 4x4 configuration. Among the features: a repositioned heavy-duty stabilizer bar; new heavy-duty bearings for available 22-inch wheels; a new lightweight aluminum lower control arm and new low-drag 4x4 bearings.

The multilink coil spring rear suspension stands apart with its coil springs and multiple trailing links, progressive-rate rear springs, a heavy-duty stabilizer bar and lightweight aluminum rear shocks. Taken together, the suspensions on Ram 1500 deliver complete comfort and confidence.

# RAM BOX SYSTEM

## CLASS-EXCLUSIVE



### NEXT-LEVEL CARGO MANAGEMENT

This truck takes on any challenge, including finding a smarter, more efficient way to organize your cargo. From a maximum 1.741 l conventional cargo bed volume to the available RamBox® Cargo Management System that includes versatile, weatherproof, lockable and drainable storage bins with downward-facing illumination and a 115-volt power outlet in the driver's side bin, this is real-world capability. Even with the RamBox®, two full-size europaletts are easily accommodated with the tailgate closed. Even with the RamBox® System, full 4x8 sheets of building material are easily accommodated.

### MULTIFUNCTION TAILGATE

It has everything that a traditional tailgate has, plus split-door flexibility. The 60/40-split, swing-away doors give quick access to the cargo bed without having to lean over a traditional tailgate—even while trailering. When the job calls for it, traditional use easily handles up to 907 kg.





**UNLEASH THE  
ADVENTURE,  
EMBRACE  
THE WORK**

**FIVE DRIVE MODES**



Maintain control of your drive with the help of five different available drive modes. Choose from Normal, Tow, Snow, Sport and Off-Road to optimize performance.

**FOUR WHEEL DRIVE  
FULL TIME**



Starting from the Big Horn trim, it includes the Auto mode, which instantly transfers torque to the front only when needed, ensuring minimal fuel consumption and maximum safety.

**DROP-IN BEDLINER**



Head-Up Display projects vital driving information onto the windshield, keeping your eyes on the road and enhancing safety and convenience.

**BED UTILITY GROUP**



Includes cargo rail system with four adjustable tie-down loops, a deployable bed step and spray-in bedliner, that provides seamless, durable protection with a special finish that maximizes bed resistance. The models with RamBox are equipped with a bed divider.

**BED STEP DEPLOYABLE &  
IN-BED LED LIGHTING**



Controlled by a switch or a key fob button, these available lights let you load any time, with no adjustment to a tonneau cover (included in Bed Utility Group).

**POWER TAILGATE**



The new powered tailgate now also closes at your command (check availability; not available with the multifunction tailgate) using the key fob, which also controls the doors, RamBox locks, Air Suspension mode (if equipped), and Remote Start for engine warm-up and tailgate access.



**420 HP  
636 NM**



# **TRADESMAN**

## **BUILT FOR HARD WORK**

Designed for those who want a no-frills pickup built for work, with 1,000 kg of payload, six seats with cloth upholstery and comes equipped with part-time 4WD with 50% torque distribution to both the front and rear axles, and low-range gearing for handling challenging conditions. Built for functionality and durability, the Tradesman includes practical features like an 8.4-inch screen featuring navigation via Apple CarPlay and Android Auto, 18-inch wheels, heavy-duty shocks, a durable drop-in bedliner and a

The 6th generation of RAM 1500 comes standard with advanced safety features across the lineup, including adaptive cruise control, pedestrian detection, and blind-spot monitoring with rear cross-path detection, ensuring comprehensive protection and peace of mind.



**420 HP  
636 NM**



Availability of shown equipment may vary.



# **BIG HORN**

## **CAPABILITY WITH VERSATILITY**

The Ram 1500 Big Horn blends rugged capability with modern comfort and style. As the first trim to offer full-time 4WD with Auto mode, it automatically shifts torque to the front axle only when needed for slippery surfaces, enhancing traction and stability.

Equipped with a 12-inch touchscreen and dual-zone A/C, it elevates your driving experience. While featuring cloth seats, the Big Horn delivers premium functionality and a commanding presence with its black exterior accents, creating a striking, bold look.



**420 HP  
636 NM**



## **SPORT**

### **PERFORMANCE MEETS COMFORT**

The Ram 1500 Sport trim blends performance with refined comfort. As the first trim to feature leather seating, it offers a stylish and comfortable cabin. Equipped with bold 20-inch wheels, the Sport trim combines aggressive design with enhanced road performance, perfect for those who demand both power and sophistication in their truck.



**420 HP  
636 NM**



## **REBEL**

### **HONOR THE OFF-ROAD**

It flawlessly combines the rugged durability needed for off-road escapades with the comfort and elegance of a contemporary vehicle. Whether maneuvering through urban landscapes or tackling remote trails, the RAM 1500 Rebel is equipped to conquer any challenge with effortless style and poise.

This truck flexes its muscles with its distinctive purpose-built design and exceptional off-road capabilities. The 2025 RAM 1500 elevates the driving experience with its remarkable 14.4-inch touchscreen and 10.25-inch front passenger display.



**420 HP  
636 NM**



# LARAMIE

## UNLEASH LUXURY

The 2025 RAM 1500 Laramie sets a new standard in the pickup truck segment, offering the pinnacle of technology for its 420-horsepower engine. The Laramie reaches its peak with the Night version, where you can have it all: air suspension, 19 Harman Kardon speakers, a 12-inch cluster display, a 10.25-inch passenger screen, and a 14.4-inch touchscreen display.

Whether you're towing heavy loads, embarking on a long road trip, or simply commuting, the Laramie provides an exceptional driving experience that is second to none. Designed for those who refuse to compromise on quality and performance, the RAM 1500 Laramie stands out with its powerful engines, elegant interior, and advanced features.





**540 HP  
706 NM**



# LIMITED

## POWER MEETS ELEGANCE

The 2025 RAM 1500 Limited stands out as a premier choice for those seeking a blend of luxury, technology, and performance. It is the first trim to feature the powerful 540-horsepower engine, delivering an exceptional driving experience with unmatched refinement. The RAM Limited redefines what a luxury pickup truck can be, seamlessly blending high-end comfort and advanced technology.

Compared to previous models, the seats now feature updated stitching, and the front seats include a massage function for added comfort. Additionally, the RAMBox comes standard, enhancing the truck's practicality and functionality.



**540 HP  
706 NM**



# **TUNGSTEN**

## **THE PINNACLE OF LUXURY**

The 2025 RAM 1500 Tungsten is the most luxurious RAM ever, set to raise your expectations to the next level. On the exterior, the RAM 1500 Tungsten features a newly redesigned look. Distinctive Tungsten Chrome accents on the grille, badging, and trim enhance its bold and aggressive stance, giving the truck a commanding presence on the road.



# TUNGSTEN

## AN INVITATION TO ROOM IN FIRST-CLASS COMFORT

The All-New 2025 Ram 1500 Tungsten raises the benchmark for upscale pickup trucks with new luxurious features like the VIN-specific center console badge and more.

Limited, Tungsten and RHO front-seat occupants are indulged by standard, deep-cushioned seats with integrated massage settings. To that, heating, cooling and 24-way power adjustability offer the utmost in personal comfort. On these trims also the rear seats are ventilated.

The Tungsten is about to take your expectations to the next level with premium leather seating, real wood and carbon fiber accents, bright metal speakers, a suede headliner and noise-cancelling features throughout the cabin.

Exclusively on Tungsten, enjoy high-fidelity audio with exceptional clarity from the Klipsch® Reference Premiere Audio System with 23 speakers—the Highest Number of Available Speakers In Its Class. Feel every beat of your favorite playlist thanks to a high-performing 12-inch subwoofer powered by a 24-channel 1,228-watt amplifier.





**540 HP  
706 NM**



# RHO

## LIKE NOTHING ELSE OUT THERE

Roaring in with new power behind the horns, the 2025 Ram 1500 RHO pushes the limits of off-road trucks further than ever before. This truck looks aggressive from every angle, featuring a bold, heroic, textured upper grille unique to the Ram 1500 RHO, along with a new front bumper, lower grille, and exterior design elements that clearly emphasize its performance-driven nature. The RHO stands out in the lineup for its distinct focus on off-road capability and innovative design, making it a top choice for those who love to conquer challenging terrains. The rugged and aggressive styling is highlighted by reinforced skid plates, tow hooks, all-terrain tires, and a specialized grille with unique badging and robust bumpers, all contributing to its commanding appearance.



# RHO

## ROARING IN WITH NEW POWER BEHIND THE HORNS

Maintain control of your drive with the help of nine different available drive modes. Choose from Mud/Sand, Rock, Baja, Valet, Auto, Tow, Snow, Sport and Custom to optimize performance—and know that you're equipped with more drive modes than the other competitors.

The Bilstein® Black Hawk® e2 Shock System monitors vehicle sensors and continuously adapts to speed, throttle position, braking, torque, steering angle and more to obtain optimal body control on road and off. Each shock is fueled by a pressurized nitrogen gas charge in an independent remote reservoir.

This heavy-duty locking differential system is designed to provide complete axle engagement when needed, allowing both rear wheels on an axle to spin as one.

Inside, the RHO balances durability with comfort. The sporty center console-mounted shifter with manual shift mode lets you stay in control of the road ahead.

Off-roading doesn't have to be rough. Experience 12-way power driver and front passenger premium leather-trimmed bucket seats, available carbon fiber accents, black metal speaker covers, an available world-class sound system and noise-cancelling features throughout the cabin.

Launch Control Mode helps to eliminate wheelspin while launching off the line so that this truck can perform at a premium without working harder than it needs to.



# RAM 1500 TRIM LEVELS

## TRADESMAN



### POWERTRAIN

- 3.0L Hurricane I6 Twin Turbo 420 Hp
- 8-speed automatic

### INTERIORS

- Cloth seats, front bench (6 seats)
- Uconnect®5 with 8.4-Inch touchscreen display
- Navi with Apple Carplay & Google Android Auto
- 3.5-inch Cluster TFT Color Display
- 6-speakers
- Urethane steering wheel
- 40/20/40 Split Bench Seat
- 2nd Row In Floor Storage Bins
- Dual Exhaust with Black tips
- USB port
- Fog lights fr/rr
- Manual folding exterior mirrors
- Rear power sliding window
- Remote Keyless entry
- Parkview Rear Back-Up Camera
- ParkSense FR/RR Park Assist W/ STOP
- Manual tilt/telescoping steering column
- A/C Auto
- Power-sliding rear window

### EXTERIORS

- 18-Inch Black Painted Aluminum Wheels
- Body color bumpers
- Black exhaust tips
- Black badges

### FUNCTIONALITY

- Electronic shift-on-the-fly part-time transfer case
- Class IV hitch receiver
- Drop-in Bedliner
- Remote Start System
- Keyless push-button start
- 3.92 rear axle ratio

### SAFETY

- 6 air bags,3 including driver and front-passenger, side-curtain and front-seat side-mounted
- Blind spot monitoring with rear cross path and trailer detection
- Forward Collision Mitigation
- Pedestrian Emergency Braking
- Active Lane Management System
- Hill start assist
- Adaptive Cruise control
- Blind-spot and cross-path detection
- Sentry Key® Theft Deterrent System
- Remote Keyless Entry
- Parkview® Rear Back-Up Camera
- Rear-Seat Reminder Alert

## BIG HORN



### POWERTRAIN

- 3.0L Hurricane I6 Twin Turbo 420 Hp
- 8-speed automatic

### INTERIORS (includes select Tradesman features plus:)

- Deluxe Cloth Bucket Seats (5)
- Uconnect®5 Nav with 12.0-Inch Touchscreen Display
- 7-inch Cluster TFT Color Display
- 9 amplified speakers with Subwoofer
- Dual Zone A/C
- Heated and Ventilated Front Seats
- Wireless Charging-Pad
- Power 10-way Driver & Passenger Leather Bucket Seats (with 2-way Lumbar adjust)
- Heated Steering Wheel
- Leather-wrapped steering wheel with audio controls
- Active noise control

### EXTERIORS

- 20x9.0-Inch Black Painted Clad Aluminum Wheels
- Black Tubular Side Steps by Mopar

### FUNCTIONALITY

- Electronic shift-on-the-demand full-time transfer case
- Remote Tailgate release
- Power Adjustable Pedals w/ Memory

### OPTIONAL:

- Dual-Panel Panoramic Sunroof

## SPORT



### POWERTRAIN

- 3.0L Hurricane I6 Twin Turbo 420 Hp
- 8-speed automatic

### INTERIOR (includes select Big Horn features plus:)

- Leather-trimmed Bucket Seats
- Uconnect®5 Nav with 12.0-Inch Touchscreen Display
- 7-inch Cluster TFT Color Display
- 9 amplified speakers with Subwoofer
- 4 Way Front Headrests
- Heated Exterior Mirrors with Memory
- Auto Power-Folding Mirrors
- Auto Dimming Exterior Driver Mirror
- Exterior Mirrors Courtesy Lamps
- Ext. Mirrors w/Supplemental Signals
- Black Interior Accents
- Full Length Upgraded Floor Console
- Rear 60/40 Folding Split Recline Seat
- Heated and ventilated front seats with memory
- LED ambient interior lighting
- Auto-dimming rearview mirror

### EXTERIOR

- 20x9.0-Inch Premium paint/polish aluminum Wheels
- Chrome "RAM" Badge
- Sport Performance Hood
- Tubular side steps

### FUNCTIONALITY

- Rain sensitive wipers

### OPTIONAL:

- Dual-Panel Sunroof

## REBEL



### POWERTRAIN

- 3.0L Hurricane I6 Twin Turbo 420 Hp
- 8-speed automatic

### INTERIOR

- Luxury Leather Trimmed Bucket Seats
- 14.4-inch display Uconnect® 5 NAVI EU
- 10.25-inch Front Passenger Interactive Display
- 12-inch Digital Cluster TFT Color Display
- 19 Speakers Harman Kardon Premium Sound
- Dual Wireless Charging Pad
- Heated and ventilated front seats with memory
- Heated Second Row Seats
- Power 12-way Driver & Passenger Leather Bucket Seats (with 4-way Lumbar adjust)
- LED footwell lighting
- Integrated Voice Command
- Dual-Pane Panoramic Sunroof

### EXTERIOR

- 18x8.0-Inch Painted Mid-Gloss Black Wheels
- Black Tubular Side Steps by Mopar

### FUNCTIONALITY

- Electronic shift-on-the-demand full-time transfer case
- Rebel specific Off-road set-up:
  - Special off-road tyres
  - Off-road performance-tuned shocks
  - Selec-Speed® Control
  - Tow hooks
  - Electronic locking rear axle (eLocker)
  - Raised Ride Height
  - Skid plate underbody protection
  - Off-road truck rubber floor mats

### PREMIUM

- 4-Corner Air-Suspension
- Head-Up Display
- Digital Auto-Dimming Rear-View Mirror
- Spray-in bedliner
- Safety Group II:
  - Drowsy Driver Detection
  - Evasive Steering Assist
  - Intersection Collision-Assist System
  - Surround-View Camera System
  - Traffic Sign Recognition

## LARAMIE



### POWERTRAIN

- 3.0L Hurricane I6 Twin Turbo 420 Hp
- 8-speed automatic

### INTERIOR

- Leather Trimmed Bucket Seats
- 14.4-inch display Uconnect® 5 NAVI EU
- Front Passenger Interactive Display
- Digital Cluster 12" TFT Color Display
- 19 Speakers Harman Kardon Premium Sound
- Dual Wireless Charging Pad
- Heated Second Row seats
- 4-way lumbar support
- LED footwell lighting
- Dual-Panel Panoramic Sunroof

### EXTERIOR

- Black Headlamp Bezels
- 22x9.0 Forged Aluminium Wheel
- "RAM" Grille Badge - Black

### PREMIUM

- Electronic locking rear axle (eLocker)
- Electric side step
- 4-Corner Air Suspension
- Head-Up Display
- Digital Auto-Dimming Rear-View Mirror
- Spray-in bedliner
- Safety Group II:
  - Drowsy Driver Detection
  - Evasive Steering Assist
  - Intersection Collision-Assist System
  - Surround-View Camera System
  - Traffic Sign Recognition

### OPTIONAL

- RamBox & Multi-Function Tailgate

# RAM 1500 TRIM LEVELS

## LIMITED



### POWERTRAIN

- 3.0L Hurricane I6 Twin Turbo High Output 540 Hp
- 8-speed automatic

### INTERIOR

- Limited-specific premium quilted leather trim
- Wood interior treatment
- 14.4-inch display Uconnect® 5 NAVI EU
- Front Passenger Interactive Display
- Digital Cluster 12" TFT Color Display
- 19 Speakers Harman Kardon Premium Sound
- Dual Wireless Charging Pad
- Dual-Panel Panoramic Sunroof
- Ventilated front and rear seats
- Heated front and rear seats
- Power massage feature for front seats
- Leather-wrapped interior grab handles

### EXTERIOR

- 22x9.0-inch Premium Black Wheels
- Electric side step

### FUNCTIONALITY

- RamBox® Cargo Management System
- Bed Utility Group
- 4-Corner Air Suspension
- Power remote open / close tailgate
- Bed Utility Group
- Electronic locking rear axle (eLocker)
- 124 liter fuel tank
- Power up/down tailgate (not available with Multi-function tailgate)

### OPTIONAL

- Multi-function tailgate

## TUNGSTEN



### POWERTRAIN

- 3.0L Hurricane I6 Twin Turbo High Output 540 Hp
- 8-speed automatic

### INTERIOR

- Premium Leather Bucket Seats in Indigo/ Sea Salt
- Exclusive Center Console Badge with VIN
- Klipsch Reference Premiere Audio System 23 Specifically Tuned Speakers - Best in Class
- High Performing 12-inch Subwoofer
- Powered by a 24-Channel 1375-Watt Amplifier
- Refined Metal, Wood, and Leather Trim Pieces
- 24-Way Power Driver/Passenger Seats
- Power massage feature for front seats
- Suede headliner

### EXTERIOR

- 22x9.0-inch Aluminum Premium Painted Chrome Wheels
- Premium front fog lamps
- Chrome mirrors

### FUNCTIONALITY

- RamBox® Cargo Management System
- Tri-Fold Tonneau Cover
- Bed Utility Group
- Air Suspension, 4-Corner
- Power up/down tailgate(not available with Multi-function tailgate)
- 124 liter fuel tank

### OPTIONAL

- Multi-function tailgate

## RHO



### POWERTRAIN

- 3.0L Hurricane I6 Twin Turbo High Output 540 Hp
- 8-speed automatic

### INTERIOR

- Premium leather front high-bolster
- Power massage feature for front seats
- 19 Speakers Harman Kardon® Premium Sound
- Performanceleather-wrappedflat-bottom steering wheel with paddle shifters
- Dual-Panel Panoramic Sunroof
- Mopar® Rubber Floor Mats

### EXTERIOR

- 18x9.0-Inch Black Painted Aluminum Wheels
- MOPAR Off-Road Style Running Boards
- 6-inch Widebody fenders, box sides and flares
- Black-painted door handles and mirrors
- Mopar Hood Blackout Decal

### FUNCTIONALITY

- 35-inch Goodyear® Wrangler® Territory All-Terrain tires
- Bilstein® Black Hawk® e2 adaptive shocks
- Skid plate underbody protection
- Launch control
- Performance Drive Modes
- Dana 60TM rear axle with electronic locking differential
- Full-time BorgWarner transfer case with 4WD Auto, 4WD High and 4WD Low
- Uconnect performance page and off-road information pages
- High-performance air induction system
- Selec-speed control
- 124 liter fuel tank

### OPTIONAL

- Rambar

The information provided in this brochure is for informational purposes only. While we strive to ensure the accuracy of specifications, colors, options, and pricing, these may change or vary without prior notice, including due to the availability of components in production. For detailed and up-to-date information, please consult your authorized dealer.

# RAM 1500 SPECS

	Sales code	TRADESMAN	BIG HORN	SPORT	REBEL	LARAMIE	LIMITED	TUNGSTEN	RHO
<b>INTERIORS</b>									
3.5-inch color cluster display	JAK	S	-	-	-	-	-	-	-
7-inch color cluster display	JAL	-	S	S	-	-	-	-	-
12-inch color cluster display	JAN	-	-	-	S	S	S	S	S
8.4-inch display Uconnect 5	UPL	S	-	-	-	-	-	-	-
12-inch display Uconnect 5	UPQ	-	S	S	-	-	-	-	-
14.4-inch display Uconnect 5	UPW	-	-	-	S	S	S	S	S
6-speakers	RCG	S	-	-	-	-	-	-	-
9-speakers	RC3	-	S	S	-	-	-	-	-
19-speakers Harman Kardon®	RCA	-	-	-	S	S	S	-	S
23-speakers Klipsch Premium®	RGE	-	-	-	-	-	-	S	-
Rear camera w/ park sensor fr/rr	XAC	S	S	S	S	S	S	S	S
Surround view camera	XAK	-	-	-	P	P	S	S	S
Dual Wireless charging pad	RFX	-	-	-	S	S	S	S	S
Rain sensitive wipers	JHC	-	-	S	S	S	S	S	S
Remote start system	XBM	S	S	S	S	S	S	S	S
Rear power sliding window	GFE	S	S	S	S	S	S	S	S
Rear view auto dimming mirror	GNK	-	S	S	S	S	S	S	S
Auto dimming ext driver mirror	GNZ	-	S	S	S	S	S	S	S
Auto dimming ext pass. mirror	LEU	-	-	-	-	-	S	S	S
Power heated mirrors	GUK	-	S	S	S	S	S	S	S
Auto A/C single zone	HAA	S	-	-	-	-	-	-	-
Auto A/C dual zone	HAF	-	S	S	S	S	S	S	S
Digital rear view mirror	GRG	-	-	-	P	P	S	S	S
Head-up display	LBK	-	-	-	P	P	S	S	S
Heated steering wheel	NHS	-	S	S	S	S	S	S	S
Heated front seat	CMA	-	S	S	S	S	S	S	S
Heated rear seat	JPZ	-	S	S	S	S	S	S	S
Ventilated front seat	CAJ	-	-	S	S	S	S	S	S
Ventilated rear seat	CAH	-	-	-	-	-	S	S	S
Back Massage front seat	CE9	-	-	-	-	-	S	S	S
Seating		6	5	5	5	5	5	5	5

	Sales code	TRADESMAN	BIG HORN	SPORT	REBEL	LARAMIE	LIMITED	TUNGSTEN	RHO
<b>EXTERIORS</b>									
Drop-in bedliner	XME	S	S	S	-	-	-	-	-
Spay-in bedliner	XMF	-	-	-	P	P	S	S	S
4 adjustable cargo tie-down	CL2	-	-	-	P	P	S	S	S
Bed step deployable	MDN	-	-	-	P	P	S	S	S
Power up/down tailgate*	JRC	-	-	-	-	-	S	S	S
Black side step	MRU	-	S	S	S	S	-	-	S
Electric side step	MY7	-	-	-	P	P	S	S	-
European trailer hitch	XFH	S	S	S	S	S	S	S	S
4-corner air suspension	SER	-	-	-	P	P	S	S	-
eLocker rear axle	DSH	-	-	-	S	S	S	S	S
Part-time 4WD	DH9	S	-	-	-	-	-	-	-
Full-time 4WD	DH8	-	S	S	S	S	S	S	S
Rambox	XB9	-	-	-	-	-	-	S	-
Multi-function tailgate	MWK	-	-	-	-	O	O	O	-
Tri-fold Cover MOPAR	CS7	-	-	-	-	-	-	S	-
Rear Wheelhouse Liners	MWH	-	S	S	S	S	S	S	S
<b>SAFETY FEATURES</b>									
Blind spot system	XAN	S	S	S	S	S	S	S	S
Adaptive cruise control	NHZ	S	S	S	S	S	S	S	S
Pedestrian emergency brake	LST	S	S	S	S	S	S	S	S
Active Lane management	XNW	S	S	S	S	S	S	S	S
Full speed collision warning+	LSU	S	S	S	S	S	S	S	S
Intersection Collision assist	XPS	-	-	-	P	P	S	S	S
Traffic Sign Recognition	SJB	-	-	-	P	P	S	S	S
Drowsy Driver Detection	XNM	-	-	-	P	P	S	S	S
Evasive Steer Assist	SJK	-	-	-	P	P	S	S	S
Bi-function LED headlamps	LM6	-	-	-	-	-	S	S	S
Led taillamps	LAY	-	-	-	-	-	S	S	S

S = standard, O = Optional, P = available with Premium version, - = Not available, \* = Not available with Multifunction tailgate

## WHEELS

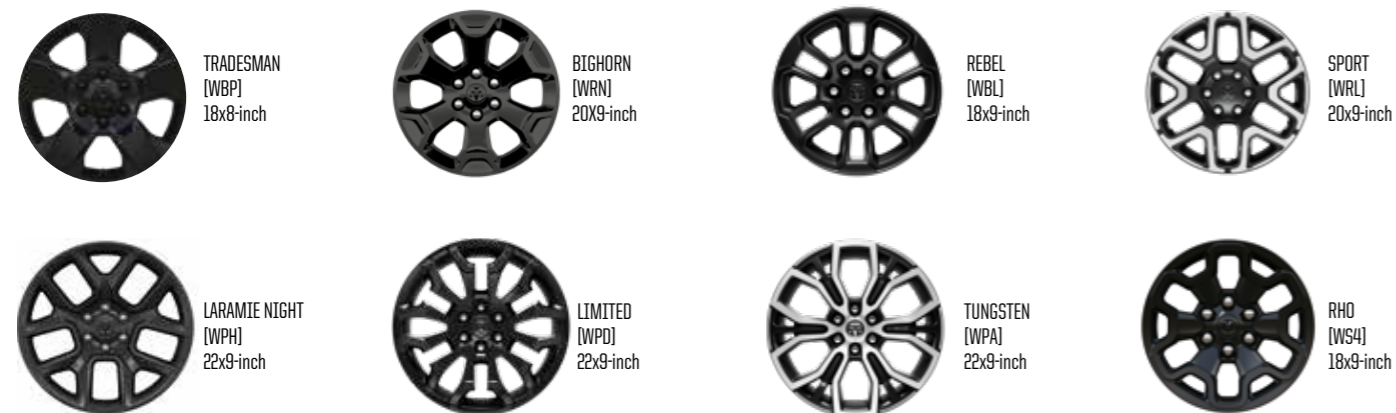

# RAM 1500 SPECS

		3.0L I6 Hurricane SO	3.0L I6 Hurricane HO
Engine			
Power max	@rpm	420 Hp/313 kW @ 5,200	540 Hp/403 kW @ 5,200
Torque max	@rpm	636 Nm @ 3,500	706 Nm @ 3,500
Consumption	l/100 km	Combined WLTP: 13,1	Combined WLTP: 14,2
CO2 emission	g/km	Combined WLTP: 311	Combined WLTP: 338
Fuel tank	l	98 (100 LPG)	125 (100 LPG)
<b>Body type</b>			
		TR-BI-SP-RE-LA-LI-TU	RHO
Turning diameter	m	14.10 (curb)	14.70 (curb)
Max speed	km/h	173 km/h	165 km/h
Overall length	mm	5,916	5,936
Overall width	mm	2,084	2,235
Overall height	mm	1,971	2,079
Wheelbase	mm	3,672	3,686
Bedfloor to ground	mm	881	983
Approach angle	mm	18.8°	31°
Departure angle	mm	20.6°	25.2°
Breakover angle	mm	19,4°	-
- with skid plate	mm	16,8°	21,9°
Ground clearance	mm	222	-
- with skid plate	mm	209	300

	ALL TRIMS	
Fuel type	Petrol (LPG optional)	
Transmission	8-speed auto	
Final gear ratio	3.92	
Kerb Weight (with driver)	kg	2,500-2,650
Payload	kg	850-1,000*
Gross total weight	kg	3,500
Max towing capacity	kg	3,500
Head room fr / rr	mm	1,038/ 995
Leg room - fr / rr	mm	1,040 / 903
Lenght at floor	mm	1,711
Cargo width	mm	1,687
- wheelhouses	mm	1,295
Tailgate open width	mm	1,525
Cargo height	mm	543

The technical specifications listed in this brochure are indicative. Vehicle characteristics may vary depending on the model, trim level, and market.

<sup>1</sup> = Fuel consumption and CO2 emission data are calculated based on the WLTP Test Procedure combined cycle. These figures may vary as vehicles are continuously tested with the latest available cycle. Actual fuel consumption and emissions may vary depending on driving conditions, vehicle configuration, and other factors.

<sup>2</sup> = Payload capacity and vehicle weight are dependent on the accessories and optional equipment installed on the vehicle. A payload capacity of 1,000 kg applies specifically to the Tradesman trim level. Actual capacity may vary based on the configuration and additional options selected.

## COLORS

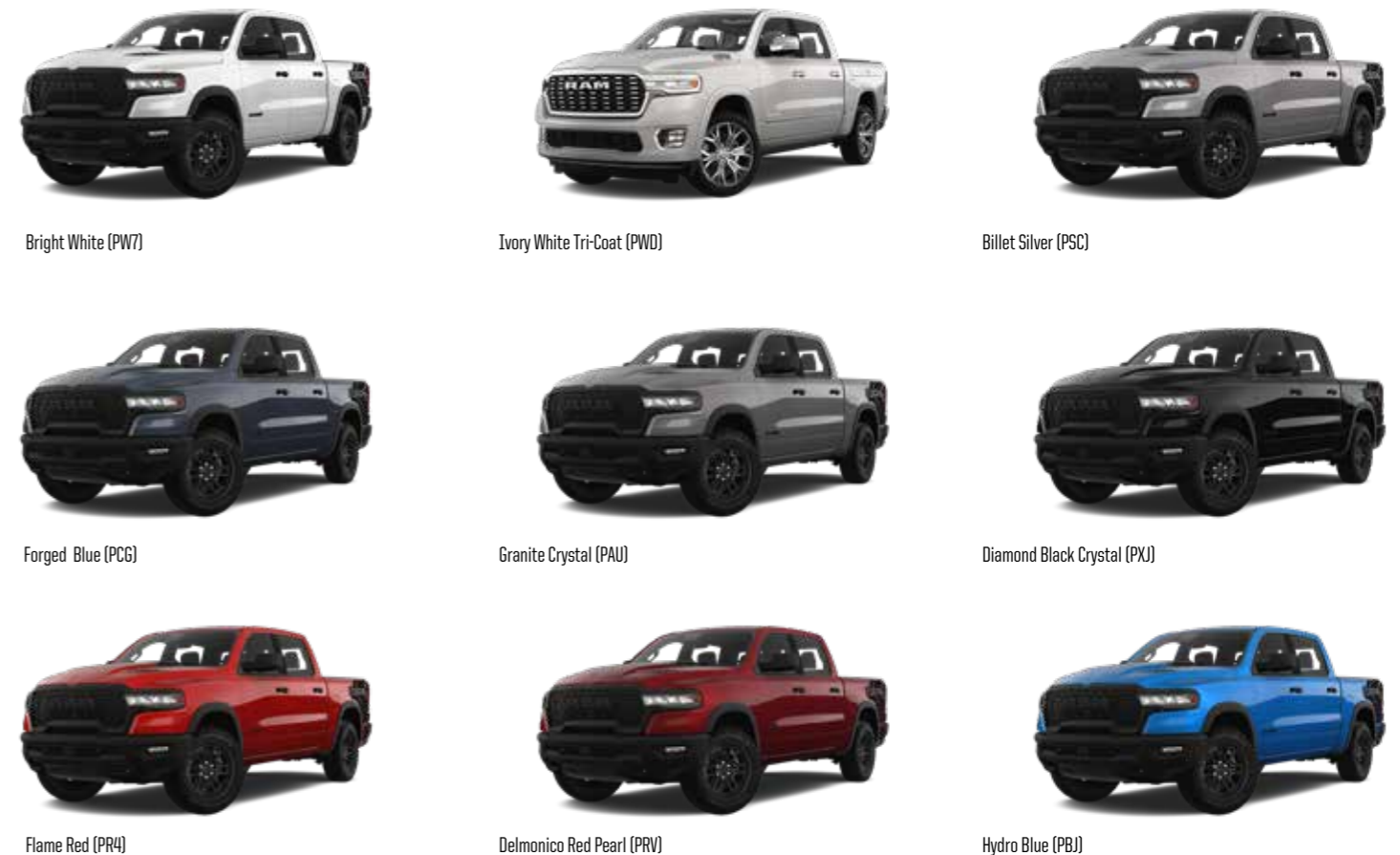







# RAM

# KW

AUTO

## SERVICES

We offer a full warranty program for your RAM through KW Warranty - part of the Klintberg & Way Group: 2 years/100,000 km throughout Europe. Relax and enjoy your vehicle.

KW Technology Center is the Klintberg & Way Automotive Technical Center, which develops high-quality solutions for the conversion and homologation of American vehicles for the European market.

Original spare parts, special parts and additions for your vehicle: 85,000 items in stock and another 3 million items from the global network with fast delivery thanks to the partnership between KW Parts and Mopar Authorized Spare Parts Distributor, which is Europe's largest spare parts wholesaler for U.S. car parts (located at: Haukadalsgatan 5, 164 40 Kista - Stockholms län - Sweden).

## KLINTBERG & WAY AUTOMOTIVE IS THE LEADING COMPANY FOR THE DODGE AND RAM TRUCKS COMMERCIAL OPERATIONS IN EUROPE.

A world made of passion, experience and competence. Our mission is to provide every dealer in the KWA network with the best tools to best serve their customers, ensuring a real American truck experience. KWA, Born to RAM.

Info at [www.kwauto.com](http://www.kwauto.com)



Stay in touch with RAM. Visit us online.

OFFICIAL DEALER